

Reaching Higher by Design

The anatomically-based, data-driven AltiVate Reverse system incorporates enhanced fixation technologies and precision instrumentation for superior fit in more of your patients.

P² Porous Coating

"Porous" porous coating that aids in the apposition of bone for superior in-growth results.

Fins

Impart rotational stability and aid in tuberosity reconstruction.

Suture Holes

Options for simplified and enhanced tuberosity reduction and fixation for fracture cases.

Stem Diameter

6mm, 8mm, 10mm, 12mm, 14mm, 16mm, 18mm

e+ Liner

Highly crosslinked vitamin E polyethylene formulated to maintain strength and reduce wear rates*.

Bone Graft Window

Increases press-fit and bony integration.

Stem Length

108mm (standard)
and 175mm and 220mm (revision)

Anatomically-Based, Data-Driven Innovation

The AltiVate Reverse stem was optimally designed to match patient anatomy for anatomic and reverse total shoulder arthroplasty, based on anatomic studies and 10 years of proven clinical data*.

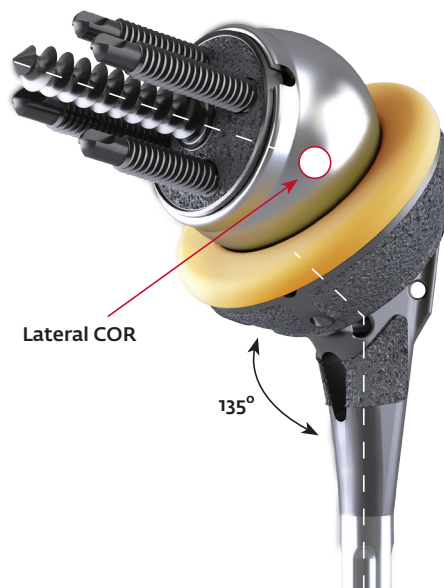

Instrumentation

The AltiVate Reverse precision instrumentation can accommodate two different surgical approaches: metaphyseal-referenced (implant position is based on the fit in the metaphysis) and diaphyseal-referenced (implant position is based on the fit in the humeral canal).

Metaphyseal-Referenced Approach

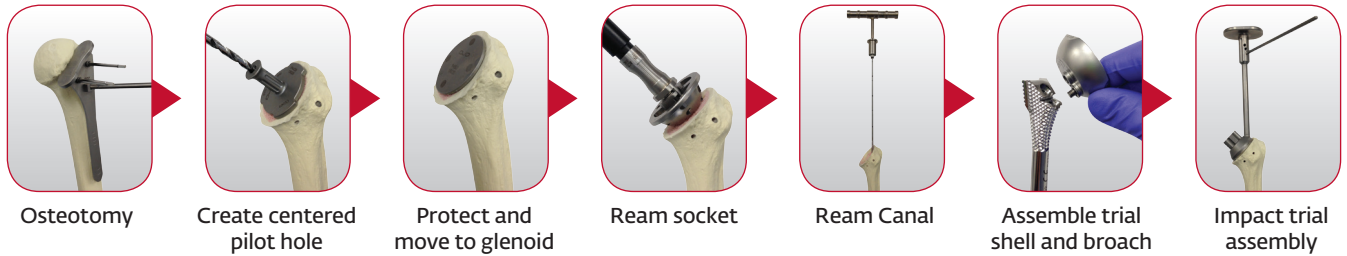

Diaphyseal-Referenced Approach



Designed With Revision In Mind

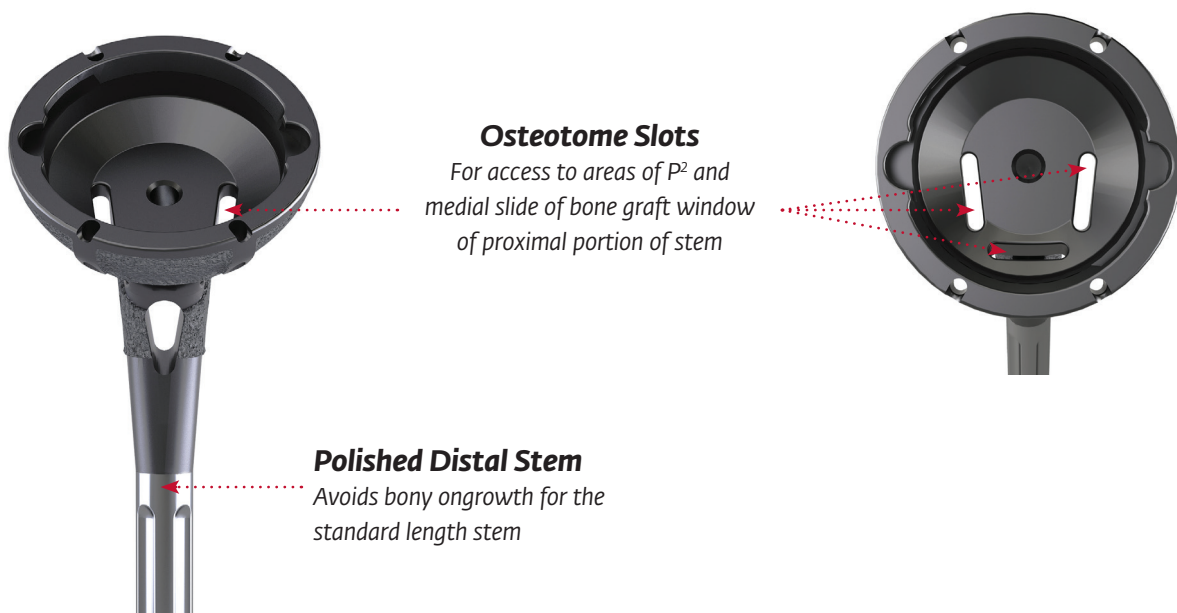

DJO Surgical | A DJO Global Company

T 800.456.8696 D 512.832.9500 F 512.834.6300

9800 Metric Blvd. | Austin, TX 78758 | U.S.A.

www.djoglobal.com/djosurgical